

Drain: MARGARET O'BRIEN **Drain #:** 124
Improvement/Arm: COVINGTON ESTATES
Operator: J. LIVINGSTON **Date:** 5-8-04
Drain Classification: Urban/Rural **Year Installed:** 1997

GIS Drain Input Checklist

- Pull Source Documents for Scanning 
- Digitize & Attribute Tile Drains _____
- Digitize & Attribute Storm Drains _____
- Digitize & Attribute SSD _____
- Digitize & Attribute Open Ditch _____
- Stamp Plans _____
- Sum drain lengths & Validate _____
- Enter Improvements into Posse _____
- Enter Drain Age into Posse _____
- Sum drain length for Watershed in Posse _____
- Check Database entries for errors _____

There were no written objections on file.

The Surveyor presented his report to the Board. (H. I.)

"

August 22, 1997

To: Hamilton County Drainage Board

Re: Margaret O'Brien Drain, Covington
Estates Arm

Attached is a petition from Covington Estates, Inc. for an arm to Margaret O'Brien Drain. The arm is to allow for the offsite drainage of Covington Estates, Section 4.

The proposed arm is a re-route of drainage originally planned for the R. J. Craig Drain. The 36" Line Reconstructed by Hills Real Estate Group, LP for the Wellington Place Apartments is at over capacity according to the drainage report by Stoeppelwerth & Associates, Inc. which is attached. Per the report, the apartments and Covington Estates should have been allowed a discharge rate of 0.38 cfs per acre. However, the pipe has 31.96 cfs which is greater than the 20.14 cfs allowable leaving the allowable 6.92 cfs from Covington nowhere to go. The proposed drainage shed for this 36" pipe by Weihe Engineers is also attached.

The proposed line shall run north along the east R/W of Lantern Road 110 feet between Covington Estates and a 10x10 concrete box structure thence west under Lantern Road 90 feet to a 6x10 concrete structure; thence west 320 feet to 72" diameter manhole; thence northwest emptying into lake 3A for Delaware Park. The plan and cost estimate by Stoeppelwerth & Associates, Inc. is attached.

The cost estimate of \$76,289.00 is to be divided between the Wellington Place Apartments and Covington Estates based on percent of acreage. With the apartments at 53 acres and Covington at 18.2 acres, the percentage of shed is 74% and 26% respectively.

The lots in Covington Estates Section 4 should be assessed to the O'Brien Drain upon construction of this line.

Kenton C. Ward
Hamilton County Surveyor "

Mr. Holt made the motion to approve the Surveyor's report for the relocation/reconstruction of the Margaret O'Brien Drain, seconded by Mrs. Clark and passed unanimously.

The Board determined in writing that the costs, damages and expenses will be

This copy printed from the Digital Archive of the Hamilton County Surveyor's Office; One Hamilton Co. Square, Ste. 188, Noblesville, In 46060
less than the benefits accruing to the owners of land benefited.

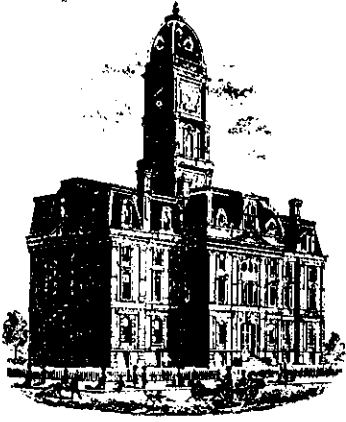

SURVEYOR'S OFFICE

Hamilton County

Kenton C. Ward, Surveyor

Phone (317) 776-8495

Fax (317) 776-9628

Suite 146

One Hamilton County Square

Noblesville, Indiana 46060-2230

July 27, 1998

To: Kent Ward
Hamilton County Surveyor

RE: Margaret O'Brien Reconstruction

FINAL INSPECTION REPORT

Please regard this letter as the Inspector's Final Report on the Margaret O'Brien Regulated Drain Reconstruction, located in Section 15, Township 17 North, Range 5 East in Delaware Township in Hamilton County. As of the date above I do hereby attest to and agree that the design plans and additional change order has been done by Sweeney Construction Corporation.

All grade checks and asbuilts have been submitted by Stoepfelwerth Engineers. All other inspections have been performed by myself. Notarized statement of all expenses incurred for labor and materials paid and received. All Claims Paid in Full!

Claim Order #1	-----	\$56,858.00
Retainage	-----	- \$8,528.70
Total	-----	\$48,329.30

Claim Order #2	-----	\$18,493.00
Retainage	-----	- \$2,773.95
Total	-----	\$15,719.05

Claim Order #3	-----	\$1,488.00
Change Order #1 - 2 30" RCP	-----	- \$564.00
Retainage	-----	- \$307.80
Total	-----	\$1,744.20

Claim Order #4	-----	\$1,900.00
Retainage	-----	- \$285.00
Total	-----	\$1,615.00

Claim Order #1	-----	\$48,329.30
Claim Order #2	-----	\$15,719.05
Claim Order #3	-----	\$1,744.20

Claim Order #4-----+ \$1,615.00
Total Claim Orders-----\$67,407.55

Total Claim Orders-----\$67,407.55
Total Amount Retained-----+ \$11,895.45
Total Reconstruction Cost-----\$79,303.00

Total Reconstruction Cost-----\$79,303.00
Contractor's Bid-----\$78,739.00
Difference In Cost Due To Change Order-----\$564.00

Engineers Estimate-----\$79,374.00
Total Reconstruction Cost-----\$79,303.00
Difference between Engineer's and Contractor's Cost-----\$71.00

This Office's recommendation is to place the balance in the maintenance fund.
This will help pay repairing any areas where erosion or seeding did not take hold.

Sincerely,

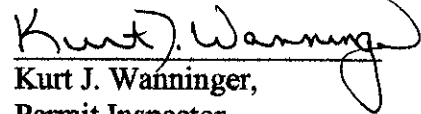
Kurt J. Wanninger,
Permit Inspector

CERTIFICATE OF COMPLETION AND COMPLIANCE

Address of premises on which land alteration was accomplished N. Hauge Rd. (Margaret O'Brien Ditch)

Inspection Date(s): _____ Permit No. _____

Relative to plans prepared by: Stoepelwerth & Associates, Inc.
on 5/29, 1997.

I hereby certify that:

To the best of my knowledge, information and belief such land alteration has been performed and completed in conformity with the improved plan, except None

Signature Jeffery W. Darling Date: 6/10/98
2/5/97

Type Name: Jeffery W. Darling Phone: (317) 849-5935

Business Address: 9940 Allisonville Fd., P.O. Box 509007, Fishers, IN 46250

Surv. X Engr. Arch. Indiana Registration No. R.L.S

(SEAL)



FORMS/CERTCOM

FILED
JUN 11 1998

HAMILTON COUNTY DRAINAGE BOARD



LETTER OF TRANSMITTAL

STOEPPELWERTH & ASSOCIATES, INC.

9940 Allisonville Road
Fishers, Indiana 46038-2005
Phone (317) 849-5935
FAX (317) 849-5942

DATE: June 10, 1998 **JOB NUMBER:** 11500

TO: Hamilton County Surveyor's Office
One Hamilton County Square
Noblesville, IN 46060

ATTENTION: Kurt Wanniger

RE: Covington Estate Section 4

WE ARE SENDING YOU Attached Under Separate cover via _____ the following items:

COPIES	SHEET NO.	DESCRIPTION
1	9	As-Built Storm Sewer (Meylor)
1		Completion and Compliance

THESE ARE TRANSMITTED as checked below:

For Approval As Requested For Review and Comment
 For Your Use _____

REMARKS:

If you have any questions, please call me at 317-849-5935.

William A. Bryant

FILED
JUN 11 1998

HAMILTON COUNTY DRAINAGE BOARD
SECRETARY



SURVEYOR'S OFFICE

Hamilton County

Kenton C. Ward, Surveyor

Phone (317) 776-8495

Fax (317) 776-9628

Suite 146

One Hamilton County Square

Noblesville, Indiana 46060-2230

To: Hamilton County Drainage Board

October 9, 1998

**Re: Margaret O'Brien Drain Reconstruction:
Covington Est. Arm**

Attached are as-builts, certificate of completion & compliance, and other information for Covington Estates Arm to the Margaret O'Brien Drain. An inspection of the drainage facilities for this section has been made and the facilities were found to be complete and acceptable.

During construction, changes were made to the drain which will alter the plans submitted with my report for this drain dated August 22, 1997. The changes are as follows:

909	813.69	810.26			
909b	815.37	809.92	30" - 2	119	114
909b	815.37	809.92			
909c	815.64	809.72	30" - 2	53	49
909c	815.64	809.72			
909d	818.17	808.97	42"	358	356
909d	818.17	808.97			
909e		808.77	42"	76	81

The length of the drain due to the changes described above is now **606 feet**.

The reconstruction was done by Sweeney Construction Corp. The contract price was \$78,739.00 and the engineers estimate was \$78,374.00. The project cost including change orders, reductions, and the bid amount was totaled at \$78,303.00. The result being that the project was \$71.00 under estimate. These figures are explained in the final inspection report dated July 27, 1998.

SCALE: 1"=50' HOR.
1"=5' VERT.

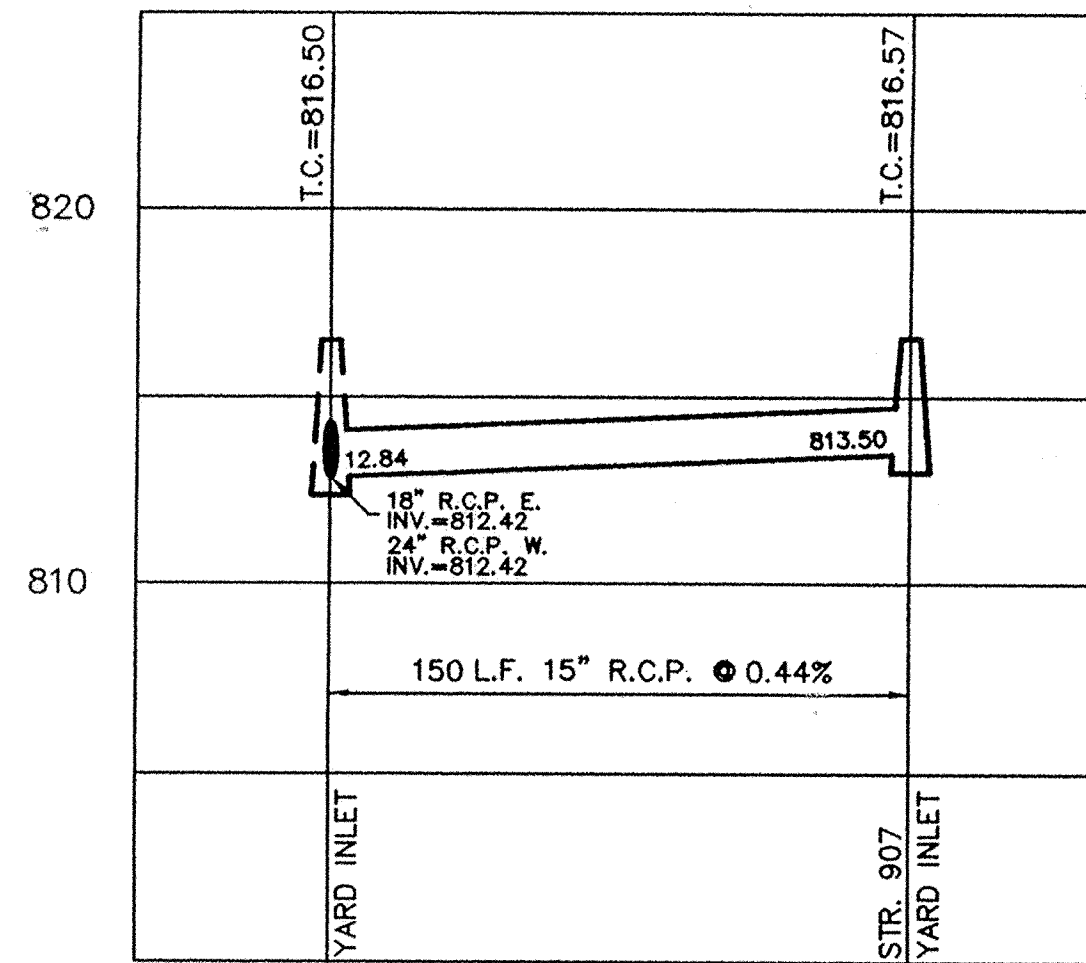

CURB INLET TABLE

PIPE SIZE	STRUCTURES LESS THAN 48" FROM T/C TO INVERT	STRUCTURES GREATER THAN 48" FROM T/C TO INVERT	ANGLE AND QUALITY OF PIPES WILL REQUIRE SPECIAL DESIGN	STEPS REQUIRED	CURB CASTING *R-3501 N	CASTING *3501 TL & TR
12" to 18"	2'x2'		DESIGN APPROVAL	No	Yes	Yes
18" or 21"		MH/BOX	DESIGN APPROVAL	Yes	Yes	Yes
21" or 27"	2'x3'*		DESIGN APPROVAL	No	No	Yes
24" or LARGER	DESIGN APPROVAL		DESIGN APPROVAL	No	No	Yes
24" or LARGER		MH/BOX	DESIGN APPROVAL	Yes**	Yes	Yes

* PIPES NO LARGER THAN 18" CAN BE USED IN THE 2' SIDE OF THIS BOX
** INCOMING AND OUT GOING PIPES EFFECT STEPS IN THIS STRUCTURE

SPECIAL NOTE:
STRUCTURES DEEPER THAN 48" FROM T/C TO INVERT WILL BE A M.H. OR A BOX WITH STEPS UNLESS SPECIAL DESIGN IS APPROVED.

SPECIAL NOTE:
STRUCTURES WILL BE DESIGNED FOR MAXIMUM FLOW IN PIPES

SPECIAL NOTE:
COUNTY MAY REQUIRE STEPS TO BE INSTALLED AFTER STRUCTURE IS SET, TO IMPROVE ACCESS.

RECORD DRAWING

Jeffery W. Darling
JEFFERY W. DARLING
Registered Land Surveyor
No. 900017

DATE 6/19/98



SCALE: 1"= 50'

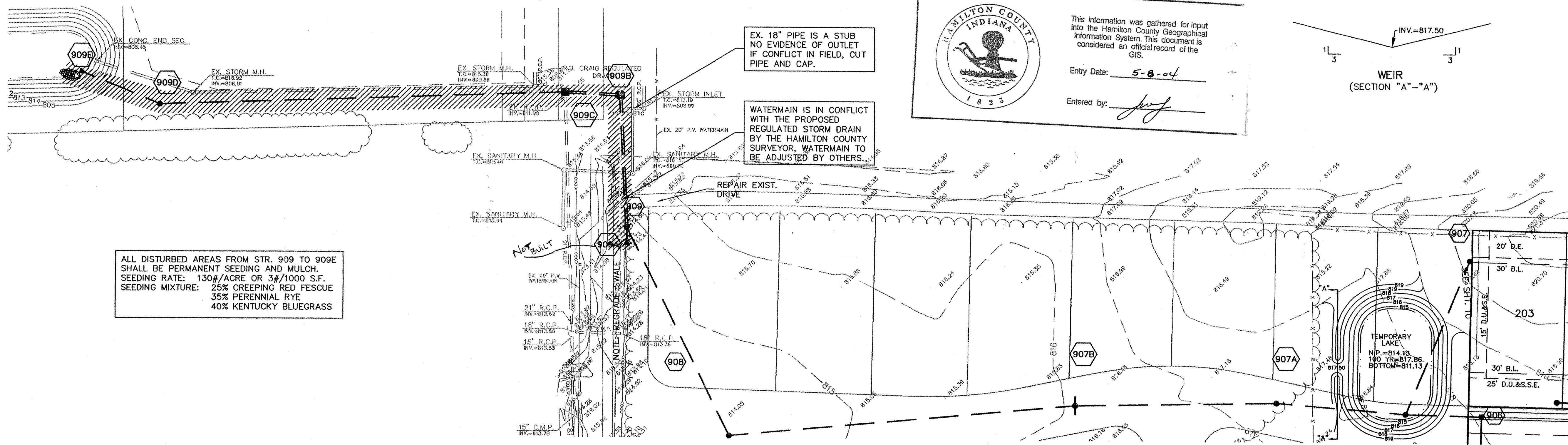

ALL DISTURBED AREAS FROM STR. 909 TO 907E SHALL BE PERMANENT SEEDING AND MULCH. SEEDING RATE: 130#/ACRE OR 3#/1000 S.F. SEEDING MIXTURE: 25% CREEPING RED FESCUE 35% PERENNIAL RYE 40% KENTUCKY BLUEGRASS

This information was gathered for input into the Hamilton County Geographical Information System. This document is considered an official record of the GIS.
Entry Date: 5-8-04
Entered by: *Jeff*

SCALE: 1"=50' HOR.
1"=5' VERT.

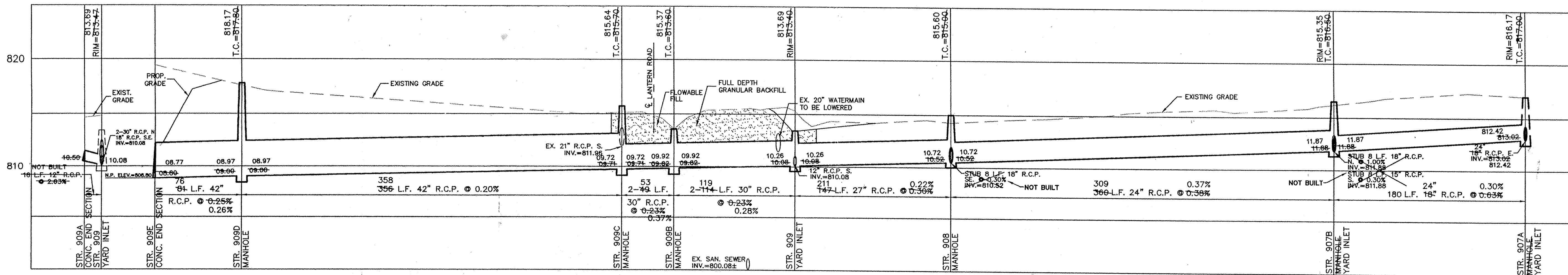

CERTIFIED: 5/29/97

CONSULTING ENGINEERS - LAND SURVEYORS
(317) 849-5935 1-800-728-6917 FAX: (317) 849-5942
INDIANAPOLIS INDIANA

STORM SEWER PLAN & PROFILE
COVINGTON ESTATES SECTION 4
FISHERS INDIANA

SHEET NO. 9
OF 15 SHEETS
JOB NO. 11500

REVISIONS

NO.	DATE	BY	REVISIONS
1	5/29/97	David J. Stoeppel	AS SHOWN
2	6/19/98	Jeffery W. Darling	REV. FOR T/C CHANGE
3	7/21/98	Jeffery W. Darling	REV. FOR T/C CHANGE